



ATV TRAILER RAMPS

MODEL H7593

INSTRUCTION SHEET

⚠️ WARNING

READ and UNDERSTAND these instructions before you use these ramps, **DO NOT** modify these ramps in any way, or severe injury or death may occur.



Model H7593 ATV Trailer Ramps.

Loading Ramp Safety Precautions

- **PREVENTING RAMP KICK-OUT.** Connect the ramp safety chains to the trailer so the ramps are tight against the trailer bed.
- **PREVENTING ATV BACK-FLIP.** Keep the ramps at the lowest angle possible where the ATV or equipment will stay on all four wheels and not flip backwards during loading.
- **PREVENTING ATV ROLLOVER.** Position the ramp feet on hard and level ground, and secure the ramp top to a level trailer. Keep the ATV load balanced on each ramp.
- **PREVENTING ATV RAMP OVERLOAD.** Remove heavy or awkward gear from the ATV luggage rack before using the ramps, and **DO NOT** exceed 500 lbs. per ramp.
- **PREVENTING ATV LOADING INJURY.** Always have a second adult person present to guide the ATV up the ramps; **NEVER** allow a novice or child to guide or load an ATV, and never stand in the rolling path of the ATV.
- **PREVENTING GENERAL INJURY.** Never use ATV Ramps if you are tired, under the influence of a medication or alcohol.
- **PREVENTING ATV BACK-FLIP.** Never ride the ATV up the ramps, or accelerate to quickly climb the ramps.

⚠️ WARNING

NEVER drive the ATV or equipment up the ramps, or severe injury or death may occur.

Setup/Use

1. Check and make sure your ATV weighs less than 1,000 Lbs. If it weighs more than 1,000 Lbs. **DO NOT** use these ramps.
2. Make sure the towing vehicle transmission is in park, the parking brake is set, and that the trailer is properly connected and is level.
3. Position the ramps on hard-level ground, and on the trailer bed at the lowest possible angle.
4. Connect the ramp safety chains to the trailer, so the ramps are supported tightly against the trailer bed, and will not kick out during ramp use.
5. Using an electric or manual winch, draw the ATV up the ramps and onto the trailer bed, **DO NOT** drive the ATV up the ramps.
6. Secure the ATV to the trailer bed according to Department of Transportation regulations, and stow the trailer ramps.

For help with ATV Ramp use or installation, call our Technical Support at: (570) 546-9663.

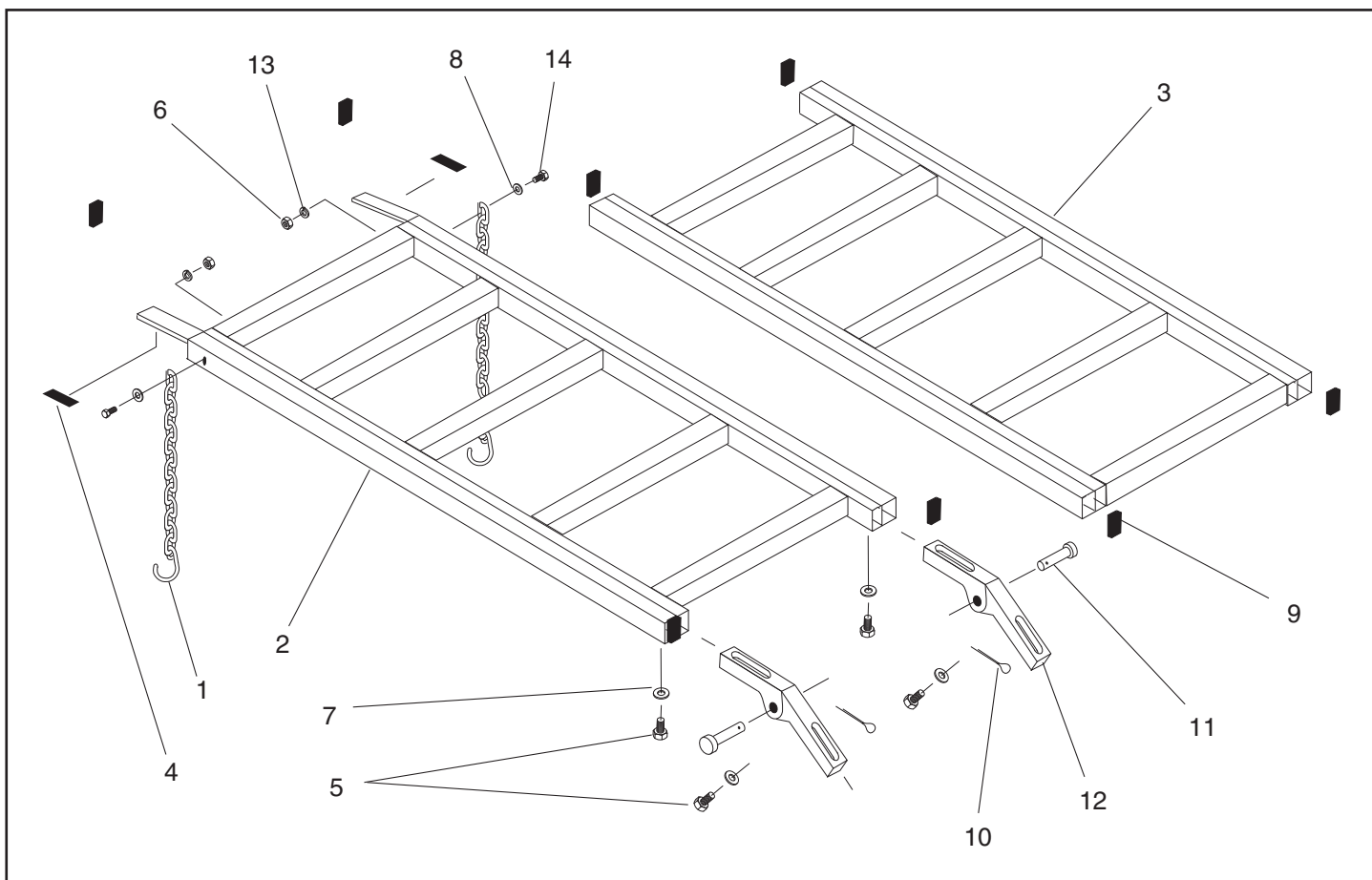

Model H7593 ATV Trailer Ramps.

Inventory/Parts

Assembled Ramp W/Safety Chain 2

1	PH7593001	SAFETY CHAIN W/HOOK
2	PH7593002	UPPER RAMP BODY
3	PH7593003	LOWER RAMP BODY
4	PH7593004	FRICTION PAD
5	PB06M	HEX BOLT M8-1.25 X 12
6	PLN03M	LOCK NUT M6-1.0
7	PW01M	8MM FLAT WASHER
8	PW03M	6MM FLAT WASHER
9	PH7593009	TUBE PLUG
10	PH7593010	COTTER PIN 2.5MM X 17MM
11	PH7593011	STEEL CLEVIS PIN 3/8 X 1 1/4
12	PH7593012	HINGE ASSEMBLY
13	PLW03M	6MM LOCK WASHER
14	PB08M	HEX BOLT M6-1.0 X 20

COPYRIGHT © JUNE, 2005 BY GRIZZLY INDUSTRIAL, INC.

WARNING: NO PORTION OF THIS INSTRUCTION SHEET MAY BE REPRODUCED IN ANY SHAPE OR FORM WITHOUT THE WRITTEN APPROVAL OF GRIZZLY INDUSTRIAL, INC.

#CR7108 PRINTED IN CHINA